

## 7. Indicator Descriptions

Indicator	Status	LED Description
Power	Steady green	The ONR is powered on.
	Off	The power supply is cut off.
	Blinking red	The ONR is upgrading.
	Steady red	ONR start up failed. Contact Singtel Support if the status persists.
PON	Steady green	Fibre connection is up.
	Off	Fibre connection is down.
	Blinks 2x a second	Fibre connection set up in progress.
	Steady red	Optical signals are down. Contact Singtel Support if the status persists.
TEL 1 - TEL 2	Steady on	Corresponding voice service is up.
	Blinking	Voice service is up & the phone is off-hook or ringing.
	Off	Voice service is down/not available.
LAN 1 - LAN 2	Steady on	Ethernet connection is up.
	Blinking	Data is being transmitted on the ethernet port.
	Off	Ethernet connection is not set up.
Internet	Steady on	Internet service is up.
	Blinking	Internet data is being transmitted.
	Off	Internet service is down.
IPTV	Steady green	Singtel TV service is up.
	Blinking	STB is detected but no IP address.
	Off	No STB detected.

## Quick Installation Guide

# OPTICAL NETWORK ROUTER



## | Technical Specifications

- Power adapter input - 100–240 V AC, 50/60 Hz
- System power supply - 11–14 V DC, 2A
- Operating temperature - 0 to 40°C
- Operating humidity - 5 to 95% RH (non-condensing)
- Weight - About 220g
- System power consumption -  $\leq 6.6W$

## | Product Overview

- Optical Network Router (ONR) has 4 ethernet ports & 2 POTS ports.

# 1. What's in the box?

ONR .....



LAN network cable .....

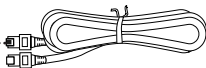

Power adapter .....

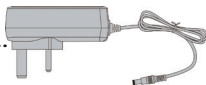

Phone cable .....



This installation guide is also included in the box.

# 2. Suggested placement of the ONR

- ⚠ Do not install the ONR outdoors/cabinets which may be exposed to sun or rain.



ONR should be placed horizontally in an open area, such as on your desk. Ports at the back of the ONR should be unobstructed.

### 3. Connecting cables and devices to ONR

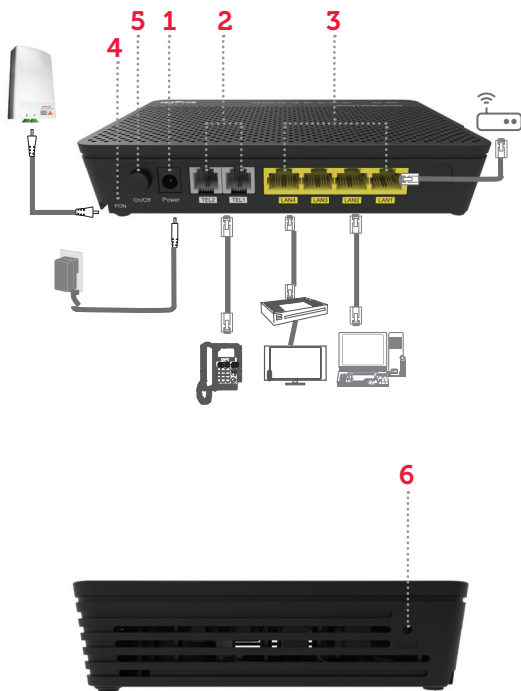

- |                        |                 |
|------------------------|-----------------|
| 1. Power port          | 4. Fibre port   |
| 2. Two telephone ports | 5. Power switch |
| 3. Four ethernet ports | 6. Reset button |

## Step 1: Connect Fibre Cable to the ONR.

1. Connect one end of the fibre patch cord to the fibre port on the back of the ONR, and secure the optical fibre by fitting it on the holders. Follow the arrows in the diagram for the positions of the holders.
2. Connect the other end of the patch cord to the fibre termination point (FTP).

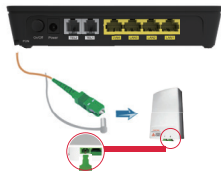
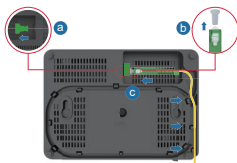

**!** As the fibre optic cables are made of glass, please do not bend sharply and ensure the bending diameter is larger than 30mm.

Step 3: Connect the LAN network cable from the Ethernet port of your device to a LAN port, e.g. Computer.

Step 4: Connect the phone cable from your phone to the assigned TEL port.

Step 5: Connect the power adapter to the ONR's Power port and your home electrical outlet. The Power indicator on the ONR should be green.

## 4. Configuring the ONR

### 4.1 Logging in to the webpage for configuration

Step 1: Connect your PC to the ONR through the Ethernet port.

Step 2: Enter **http://192.168.1.254** in the address bar of your Internet Browser and press **Enter**. When the login window is displayed, enter username (**root** by default) and password (printed on the nameplate of the device).

Step 3: Click Login.

 Your session will automatically timeout after 5 minutes of inactivity and you will be required to log in again. Replace your default password with a personal one to avoid unauthorised access.

### 4.2 Configuring the FTTH ID

Step 1: Choose Advanced Configuration > System Management > ONR Authentication.

Step 2: Input the FTTH ID (Use FTTH ID provided by Singtel).

Step 3: Click Apply. Verify your service 15 seconds later. Refer to section 5 on how to verify your service.

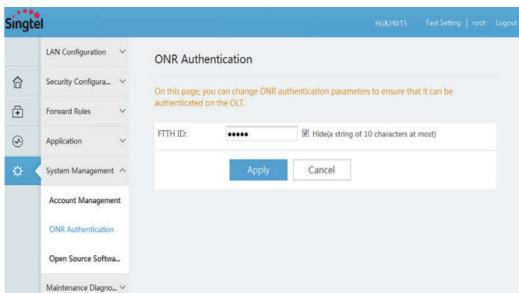

The screenshot shows the Singtel ONR web interface. The top navigation bar includes the Singtel logo, the device ID 'HG874075', and links for 'Fast Setting', 'root', and 'Logout'. A left-hand sidebar contains a menu with options: LAN Configuration, Security Configura..., Forward Rules, Application, System Management (highlighted with a gear icon), Account Management, ONR Authentication, Open Source Softwa..., and Maintenance Diagnoc... The main content area is titled 'ONR Authentication' and contains a message: 'On this page, you can change ONR authentication parameters to ensure that it can be authenticated on the OLT.' Below this is a form with a label 'FTTH ID:' followed by a text input field containing six asterisks and a checked checkbox labeled 'Hide(a string of 10 characters at most)'. At the bottom of the form are two buttons: 'Apply' and 'Cancel'.

## 5. Verify if connection is successful

LED indicators on the ONR provide status information of each service connection. Each lit indicator indicates the success of the connection listed previously in sections 3 and 4:

- Fibre connection is up if PON indicator is steady green.
- Each of these services are functioning normally if LAN/TEL/Internet/IPTV indicators are steady green.

If the PON indicator is blinking, check your fibre connection stated in section 3 and FTTH ID configuration in section 4.

Refer to section 7 for the other indicator statuses.

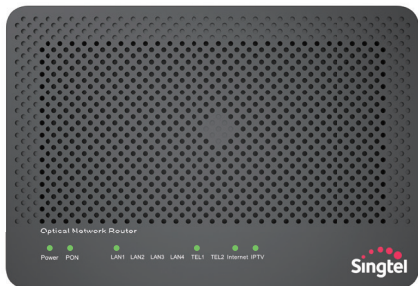

## 6. Resetting to Factory Default

### What does it do?

Resets all settings except the FTTH ID.

### How do I reset it?

Press the Reset button by using a needle-like object and hold for more than 10 seconds. If the LED indicator turns off and on, your ONR has been successfully restored to factory default.

### When should I perform a factory reset?

To reset all the settings except the FTTH ID.

Perform the reset operation if you want to erase all the data on the ONR. Please note that this operation may cause the loss of your ONR configuration information and lead to Internet connection failure. If this problem occurs, please contact your service provider for help.